



230x300 Mobilbox

Power Distribution Box With 3M Cabled Plug									
Configuration	IP 44 - CEE Norm Straight Socket-Inlet				1x16A Schuko Socket	Protection		Connection	Product No
	4x16A	5x16A	4x32A	5x32A		RCCB	MCB		
		2 Front		2 Back	2+2 = 4 Side	1 x 40A/4P/0,03A (TYP AC 40TR) (TYP A 40EU)	2 x 32A 3P-C 2 x 16A 1P-C	3M Cable H07RN-F 5G4 CEE-Plug 32A 5P 400V	3333-004-5272



Power Distribution Box With Panel Mount Inlet									
Configuration	IP 44 - CEE Norm Straight Socket-Inlet				1x16A Schuko Socket	Protection		Connection	Product No
	4x16A	5x16A	4x32A	5x32A		RCCB	MCB		
		2 Front		2 Back	2+2 = 4 Side	1 x 40A /4P/0,03A (TYP AC 40TR) (TYP A 40EU)	2 x 16A 3P-C 2 x 16A 1P-C	CEE-Inlet 32A 5P 400V	3334-004-5771

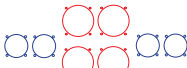

Pre-drilled Empty Power Distribution Box			
Configuration	IP 44 - CEE Norm Straight Socket-Inlet	1x16A Schuko Socket	Product No
	Suitable for all CEE panel mount plugs and sockets with 75x75 flange size: 4 products can be assembled.	Up to 4 panel sockets can be installed	3334-411-1112



Blank Power Distribution Box		
Configuration	Product Description	Product No
Blank	230x300 mobilbox	3334-000-0000



- 13 modules inside the cover.
- Cable and inlet connection options.
- It can be easily stacked.
- The box has IP44 protection.



Mechanical Specifications

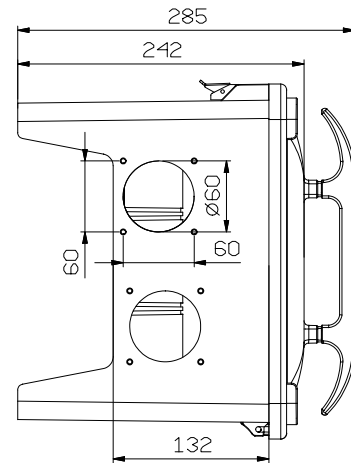
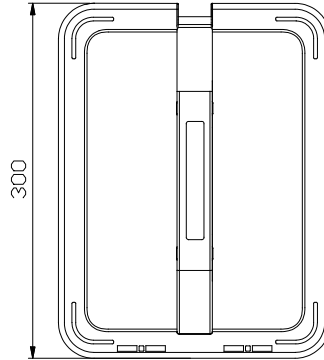
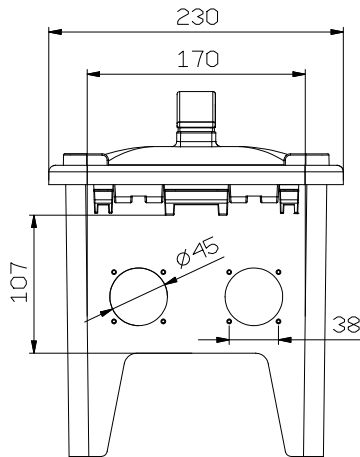

Thanks to its handle, easily moveable

Durable ABS material

Thanks to its Support Legs, it is protected against liquid contact that may come from the ground.



Cover can be easily closed and opened with the latch.



TP Electric
RCCB and MCB



Cables are hidden for your safety



It can be stacked on top of each other with its practical design.



VDE and KEMA
certified, top-quality products

